

NOTES:

1. PROVIDE INSULATED DUCT IN JOIST SPACE AS NEEDED
2. ALL CABINETS, APPLIANCES AND FIXTURES SUPPLIED BY OWNER AND ASSEMBLED AND INSTALLED BY GC.
3. PROVIDE DIRECT VENT TANKLESS GAS WATER HEATER
4. PROVIDE 95% EFFICIENT GAS FURNACE
5. USE NO SEALERS, ACCELERATORS, OR ADMIXTURES ON KITCHEN OR LOUNGE CONCRETE
6. PROVIDE WEATHERSTRIPPING AT ALL EXTERIOR DOORS
7. CONTRACTOR TO VERIFY ALL DIMENSIONS
8. ALL EXPOSED CONCRETE WALLS TO BE SANDBLASTED AND SEALED
9. PROVIDE WALL-MOUNTED CONTROL FOR OVERHEAD DOOR
10. IN-FLOOR RADIANT HEATING AT FIRST FLOOR WITH HEPEX AND NATURAL GAS BOILER W/ RECIRC. PUMP IN MECH. ROOM
11. ALL SOFFITS TO BE 3/8" PLYWOOD TYPE A-B EXT. SEALED ALL SIDES, BUTT JOINTED AND SCREWED TO UNDERSIDE OF TJI IN A REGULAR AND CONSISTENT PATTERN.
12. PROVIDE SAW CUT CONTROL JOINTS IN EXPOSED CONCRETE SLABS AT KITCHEN, LOUNGE AND DRIVEWAY
13. MECH. ROOM AND STORAGE WALLS AND CEILING SHALL RECEIVE 5/8" TYPE "X" GYP. BD. TAPED AND MUDDED ONLY.
14. ALL LIVING AREA INTERIOR WALLS AND CEILINGS TO RECEIVE PLASTER- SMOOTH FINISH THROUGHOUT
15. PROVIDE SEALED WOOD HANDRAIL AT STAIR ON ONE SIDE (RIGHT HAND ASCENDING)
16. ALL HARDWARE AND TRIM TO BE BRUSHED NICKEL OR SATIN CHROME- REFER TO DOOR SCHEDULE
17. PROVIDE HARDWOOD SHELF AND AT ENTRY- REFER TO DETAILS
18. ALL VENTING, F.A. INTAKES AND MECH. EXHAUSTS TO OCCUR ON NORTH SIDE OF HOUSE ONLY
19. PROVIDE EXPOSED CONDUIT AT CONC. WALLS FOR ALL OUTLETS
20. PROVIDE DAMPPROOFING AT ALL EXPOSED CONC. WALLS
21. PROVIDE DOOR KNOB BUMPERS AT ALL INTERIOR SWING DOORS.
22. PROVIDE SILL SEALANT AT ALL SILL PLATE LOCATIONS- PROTECTO-WRAP TRIPLE GUARD
23. BATH ACCESSORIES PROVIDED BY OWNER AND ASSEMBLED AND INSTALLED BY GC
24. ALL EXTERIOR PENETRATIONS TO BE FOAMED AND CAULKED AS NEEDED.
25. ALL WINDOWS AND DOORS TO HAVE PLASTER RETURNS- PROVIDE PERIMETER SEALANT AT ALL LOCATIONS- INTERIOR AND EXTERIOR. COLOR TO BE GREY
26. PROVIDE FELT ISOLATION STRIPS AT ALL LOCATIONS WHERE EXTERIOR CONCRETE ABUTS HOUSE FOUNDATION WALLS.
27. PROVIDE 1/2" REVEAL AND TEAR AWAY BEAD AT BASE OF ALL INTERIOR WALLS- NO WOOD BASE- PROVIDE CLEAN AND CONSISTENT REVEAL AT FLOOR/WALL INTERSECTION
28. REFER TO ELEVATION SHEETS FOR EXTERIOR CLADDING AND TRIM MATERIALS
29. HOUSE NUMBERS TO BE 6" RIBBON CONDENSED ANODIZED BLACK FINISH W/ 3/8" SPACERS FROM WWW.WESTONLETTERS.COM

FLOOR SUMMARY:

FINISHES:

- WALLS:**  
ALL INTERIOR WALLS TO RECEIVE SMOOTH PLASTER FINISH EXCEPT STORAGE AND MECH. PROVIDE TAPED AND MUD DRYWALL AT THESE LOCATIONS- NO PAINT THROUGHOUT
- FLOORS:**  
EXPOSED KITCHEN AND LOUNGE CONCRETE FLOORS SHALL RECEIVE A STEEL TROWEL SMOOTH FINISH AND DYED USING THE RETRO-PLATE SYSTEM OR EQUIVALENT.  
SUB-CONTRACTOR SHALL PROVIDE SAMPLES OF THE FOLLOWING DYES IN AN INCONSPICUOUS AREA IN THE MECH. ROOM PRIOR TO FINAL COLOR SELECTION:  
1: MAHOGANY  
2: SLATE BLUE  
3: CARAMEL
- LOUNGE AND SECOND FLOOR LIVING AREAS TO RECEIVE COMMERCIAL GRADE CARPET ON PAD- STYLE AND MANUFACTURER TO BE DETERMINED- G.C. TO PROVIDE \$6.50/S.F. ALLOWANCE FOR MATERIALS AND INSTALLATION

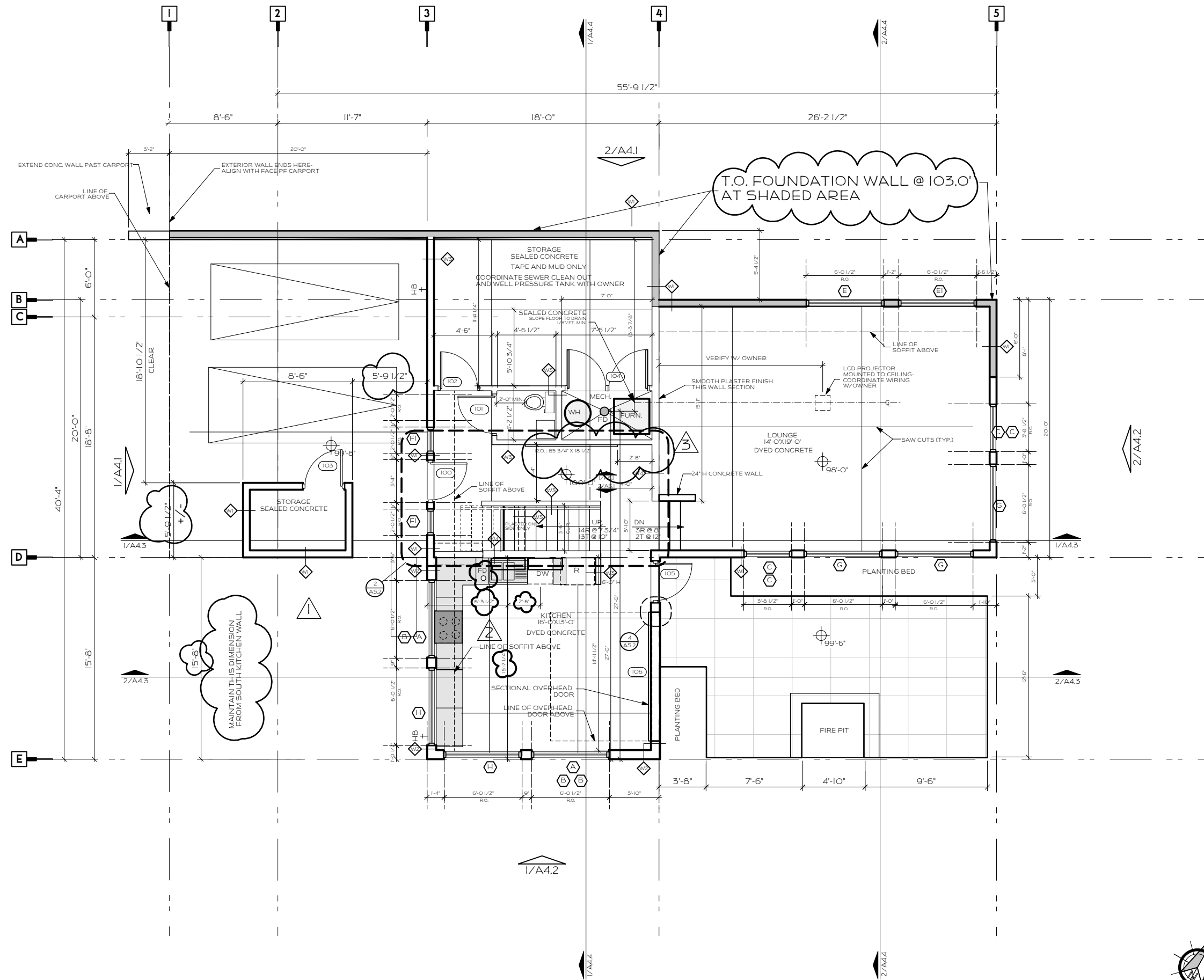

<b>Bark DESIGN</b>	
325 N. SHEPHERD STUDIO@BARK-DESIGN.COM	MADISON WISCONSIN 53711 608.333.9226 OFFICE
SPECULATIVE HOUSE THE "LEROY G. COOPER"	DRAWN BY: S.L. DATE: 05.17.07 SHEET NO.
<b>FIRST FLOOR PLAN</b>	
SCALE: 1/8"=1'-0"	